

# TAFCO

*Walk-In to Quality*

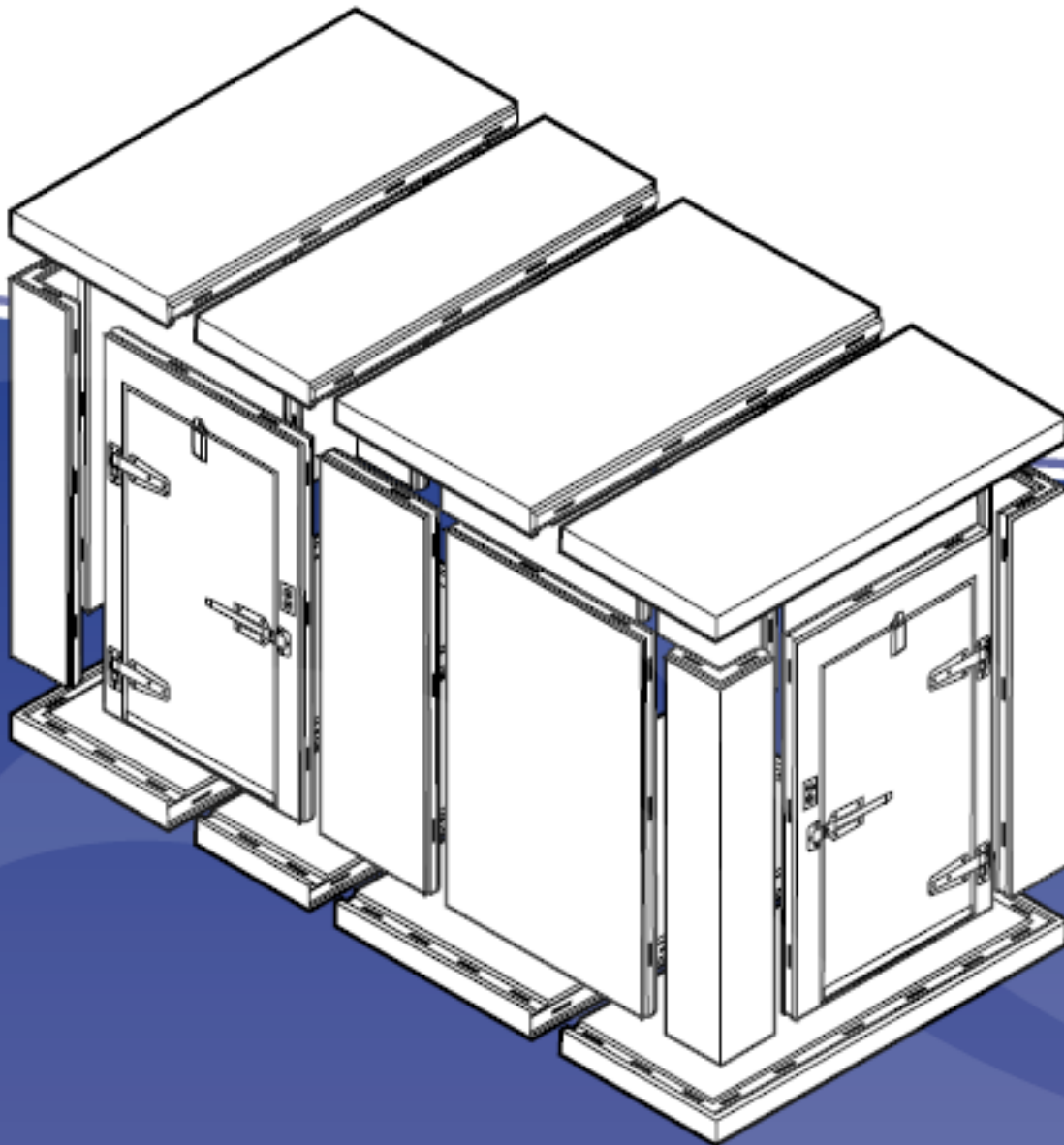

Energy Independence and Security Act of 2007 Compliant

**SLOPED MEMBRANE ROOF INSTALLATION**

# MEMBRANE ROOF INSTALLATION (Free Standing Walk-in)

## A.1

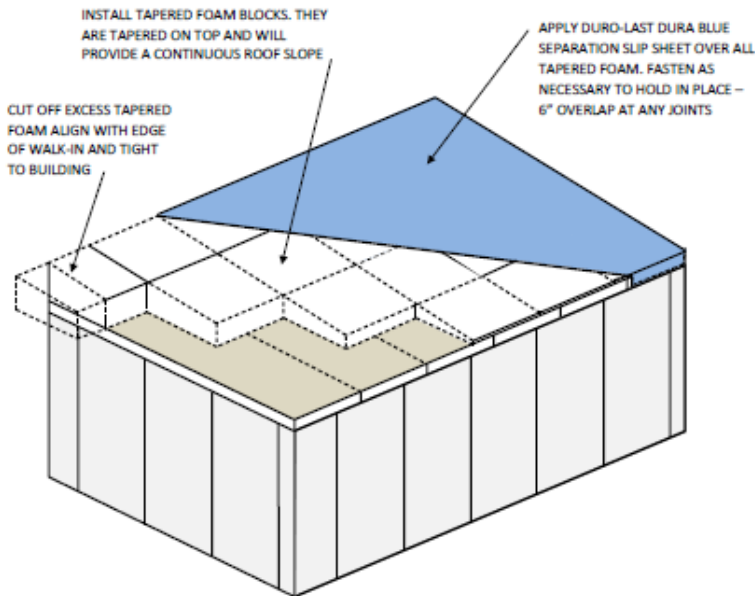

Step #1: Check the roof top if the walk-in and remove any foreign matter. Seal all protruding rough edges such as screw heads, rivets, etc with caulking. This will prevent any chance of penetrating or wearing a hole in the membrane roof cap.

Step #2: Before installation, check the overall width and length of the membrane roof cap. It should be approximately one foot wider and longer than the walk-in.

Step #3: Install tapered insulation. Align the tall edge of the tapered insulation with the edge of the walk-in ceiling panel, place in line from high side to low side.

Step #4: Install Duro-Last Duro Blue separation slip sheet to completely cover all tapered insulation and exposed edges (Figure A.1). Fasten as necessary to hold in place.

Step #5: Snap chalk line approximately 51" from edge of walk-in (Figure A). Fasten 3" tab using a 1 1/2" screw and a Duro-Last poly plate (Figure B). Start securement 6" from edge. Continue fastening, 12" on the center, until 3" tab is secured along entire tab.

Step #6: Unroll roof cap membrane to next tab and fasten. When fastening remaining tabs, check often to make sure all slack in roof cap is pulled taught.

Step #7: On completion of the roof cap tabs. Fold corners as shown (Figure C) and install flashing trim (Figure D) around perimeter of walk-in. Use 1 1/2" screws spaced 6" on center. Seal top edge of trim with caulking.

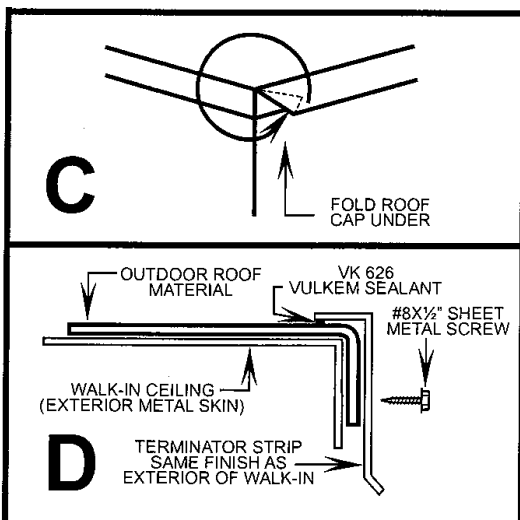
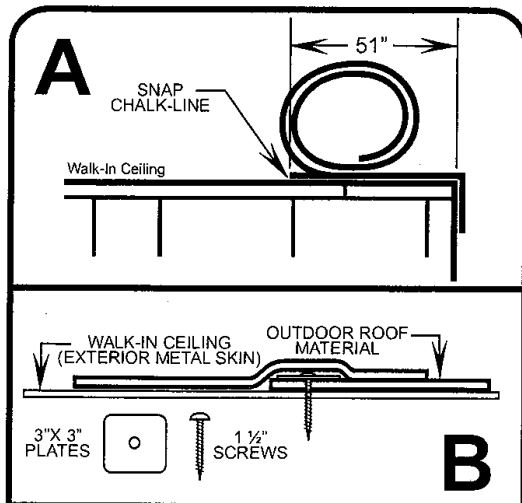

# MEMBRANE ROOF INSTALLATION (Flashed Against Building Wall)

## A.1

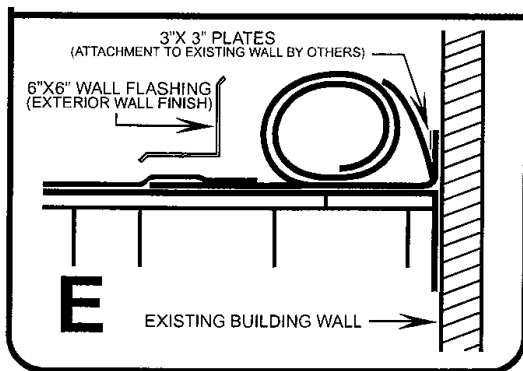
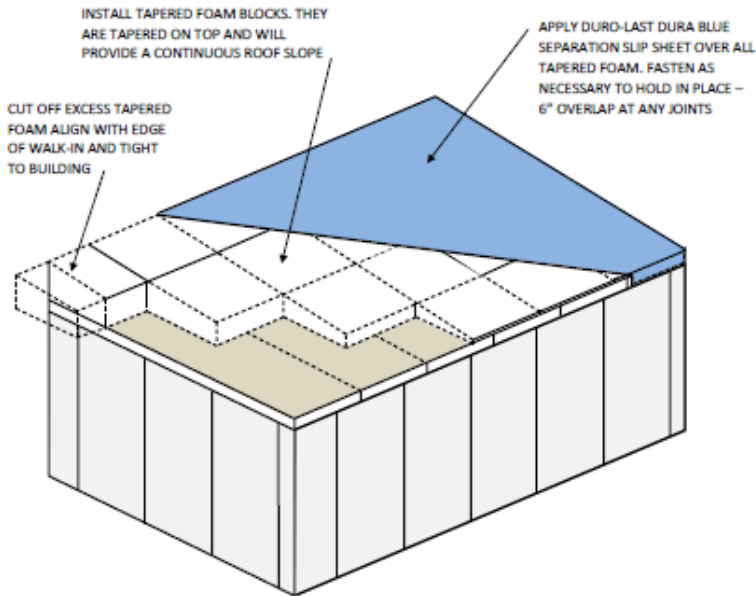

Step #1: Check the roof top if the walk-in and remove any foreign matter. Seal all protruding rough edges such as screw heads, rivets, etc with caulking. This will prevent any chance of penetrating or wearing a hole in the membrane roof cap.

Step #2: Before installation, check the overall width and length of the membrane roof cap. It should be approximately one foot wider and longer than the walk-in.

Step #3: Install tapered insulation. Align the tall edge of the tapered insulation with the edge of the walk-in ceiling panel, place in line from high side to low side.

Step #4: Install Duro-Last Duro Blue separation slip sheet to completely cover all tapered insulation and exposed edges (Figure A.1). Fasten as necessary to hold in place.

Step #5: Snap calk line approximately 51" from edge of walk-in (Figure A). Fasten 3" tab using a 1 1/2" screw and a Duro-Last poly plate (Figure B). Start securement 6" from edge. Continue fastening, 12" on the center, until 3" tab is secured along entire tab.

Step #6: Unroll roof cap membrane to next tab and fasten. When fastening remaining tabs, check often to make sure all slack in roof cap is pulled taut.

Step #7: On completion of the roof cap tabs. Fold corners as shown (Figure C) and install flashing trim (Figure D) around perimeter of walk-in. Use 1 1/2" screws spaced 6" on center. Seal top edge of trim with caulking.



**1395 Industrial Park Road,  
Clearfield, PA 16830**

**PO Box 269  
Hyde, PA 16843**

**Toll Free: (800) 233-1954  
Tel: (814) 765-9615  
Fax: (814) 765-5410  
[tafcowalkins.com](http://tafcowalkins.com)**

**Due to continuing development, specifications are subject to change  
without notice. For more information please contact us.**

© TMP Manufacturing Company, Inc. Revised September 2016. All Rights Reserved.